

Page

74
75
76
77
78
79
80 - 81
82 - 83



LIFT AND TURN LOCK

070



LH/RH

RoHS

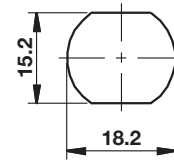
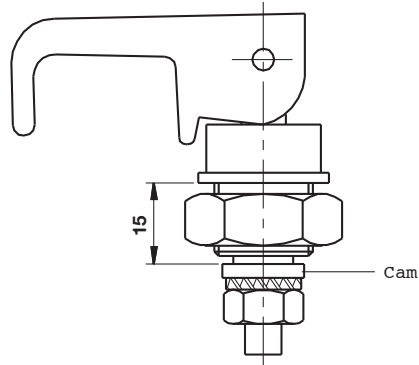

Cut out

APPLICATIONS

Electric panels, machinery covers

MATERIAL

BODY : Polyamide DIN-EN ISO
1043-1 PA6 GFR 30

CAM : Steel

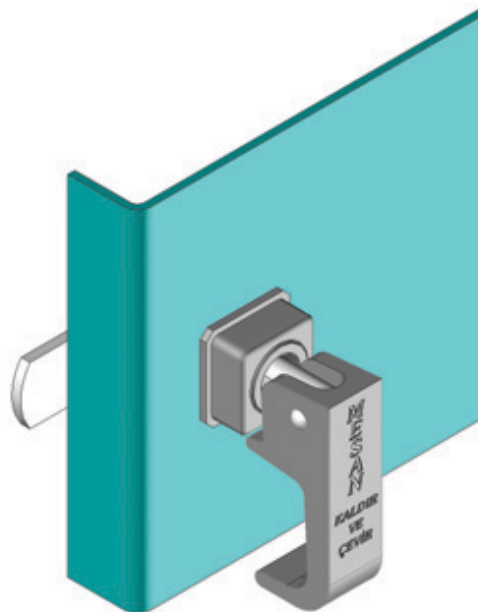

072

FUNCTIONAL LOCK

IP 54



LH

RH



RoHS



- Suitable for steel and polyester panels.
- Standard cut outs for both versions.
- Clip fixing version suitable for panels with thickness of 0.8mm to 2mm.

APPLICATIONS

Electric panels, machinery covers

MATERIAL

BODY : Polyamide DIN-EN ISO

1043-1 PA6 GFR 30

CAM : Steel or PA6 GFR 30

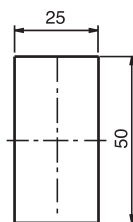
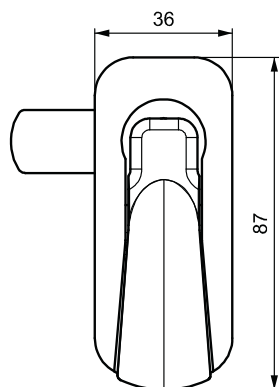

Cut out

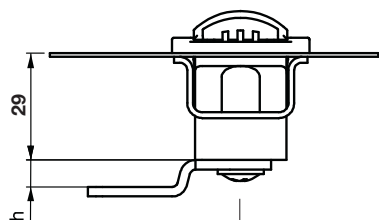

Steel cam

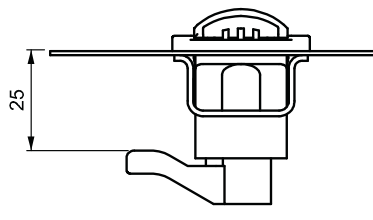

Plastic cam
CC: 80

V : 1



V : 2

Clip-in fixing



DT	
Min	Max
0.8mm	2 mm

DT (Door thickness)

PRODUCT CODE

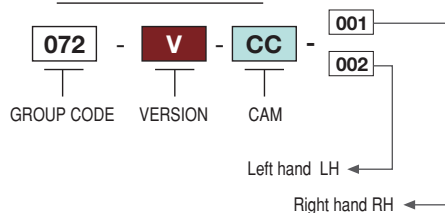

For cams please check page: 89

SLIDING LOCK

071



LH/RH

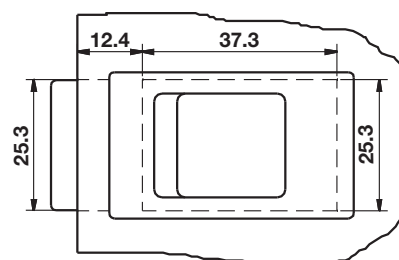
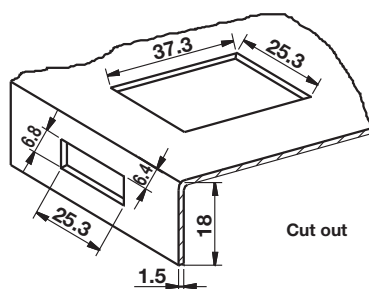
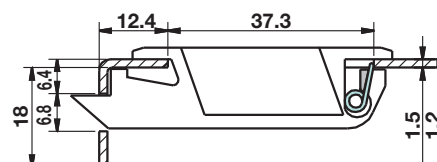
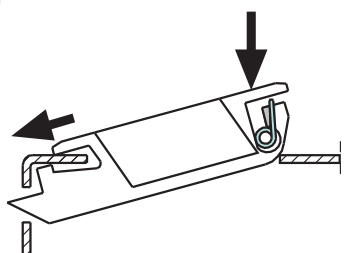

- ✚ Easy fixing. Long lasting stainless steel spring.
- ✚ Suitable for panel thicknesses of 0.8mm to 1.5mm.

APPLICATIONS

Small metal machinery covers

MATERIAL

BODY: ABS

SPRING: Stainless Steel

PRODUCT CODE

071

-

V

GROUP CODE VERSION

SPECIFICATIONS	VERSION
For 0.8 - 1.2 thickness panel	12
For 1.2 - 1.5 thickness panel	15

171

MINI SLIDING LOCK



LH/RH

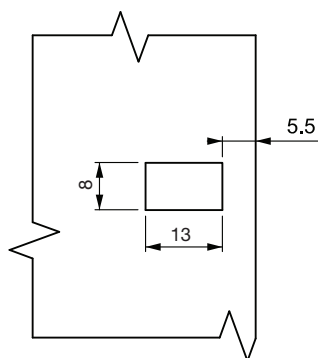
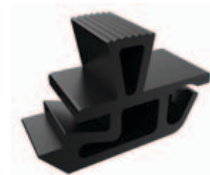

Cut out

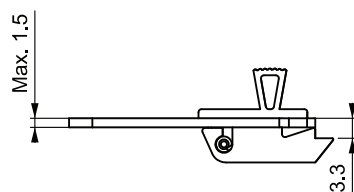
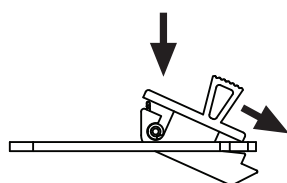
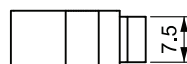
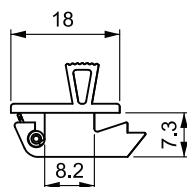

Door thickness	
Min	Max
0.8 mm	1.5 mm

☒ Suitable for small doors inside panels
☒ Suitable for panel thicknesses of 0.8 mm to 1.5 mm.

APPLICATIONS

Small metal machinery covers

MATERIAL

BODY: ABS

SPRING: Stainless Steel

PANEL LOCK WITH HEXAGONAL HEAD

075



LH/RH

RoHS

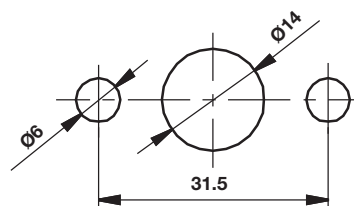
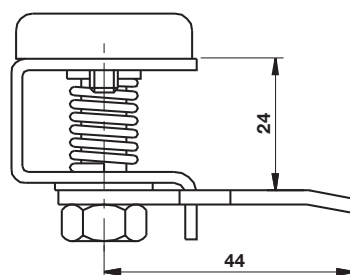
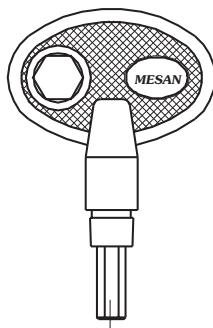

Cut out

APPLICATIONS

Electric panels, machinery covers

MATERIAL

BODY : Steel

CAM : Steel

COVER : Polietilen

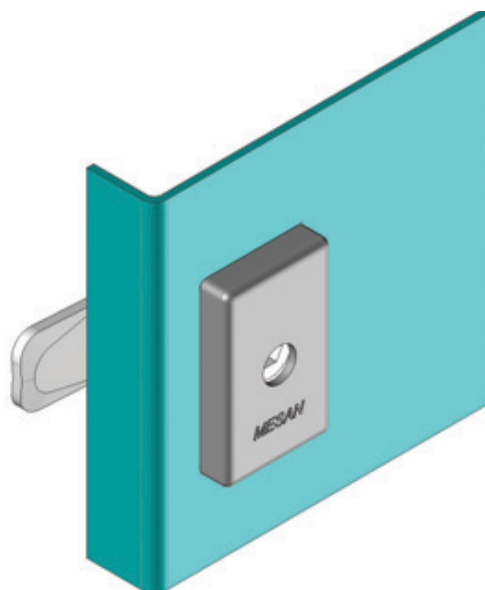

ALLEN KEY

169-66



PRODUCT CODE

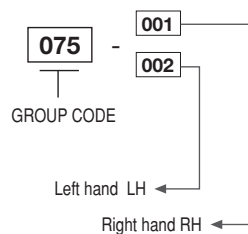

V : 1

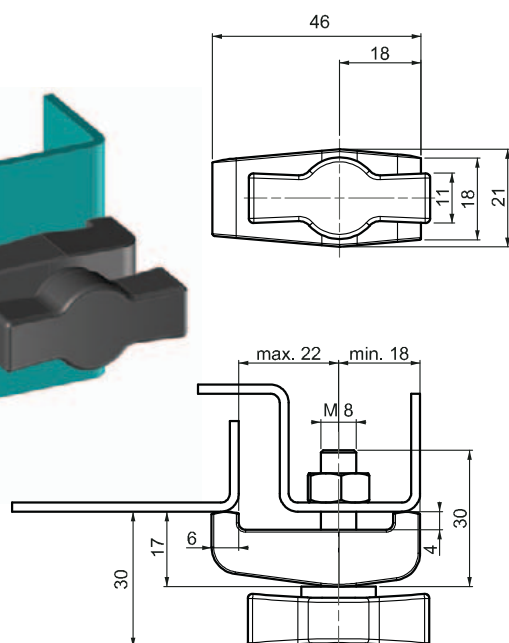
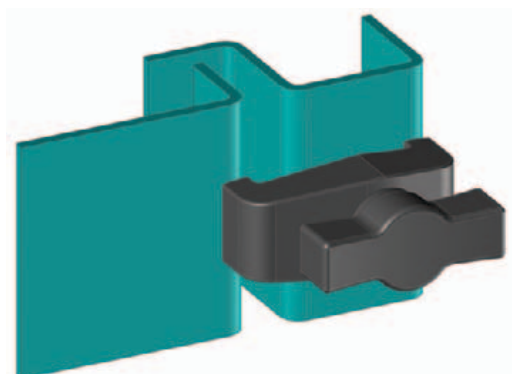

V : 2

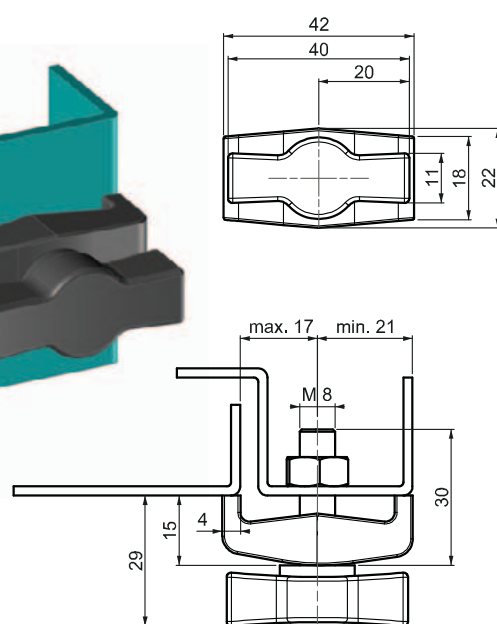
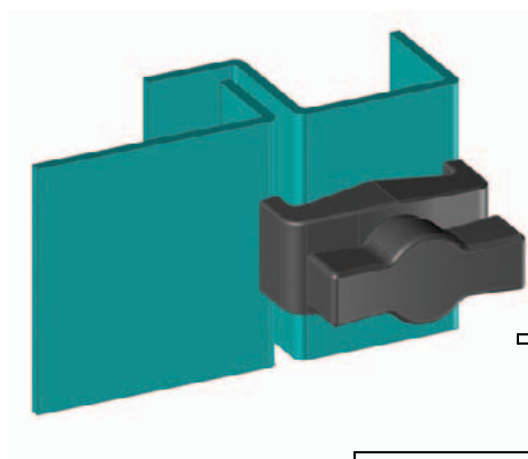

462

BRIDGE CLAMP SYSTEM

LH/RH

RoHS



APPLICATIONS
Heating and ventilation panels

MATERIAL
HOUSING : PA6 GFR 30
KNOB : PA6 GFR 30
SCREW : Steel

PRODUCT CODE

462 - **V**
GROUP CODE VERSION

HVAC LOCK

012

New



LH/RH

RoHS



- Removable handle provides easy assembly on site.
- Roller cam requires lower forces for locking.
- Cylinder and without cylinder versions are available.
- Can be used for different door thicknesses.
- Internal handle is available for opening the door from inside for safety purposes.

APPLICATIONS

Heating and ventilation panels

MATERIAL

BODY : Polyamide DIN-EN ISO
1043-1 PA6 GFR 30

KOL : Polyamide DIN-EN ISO
1043-1 PA6 GFR 30

CAM : Steel

ADJUSTABLE SCREW : Brass

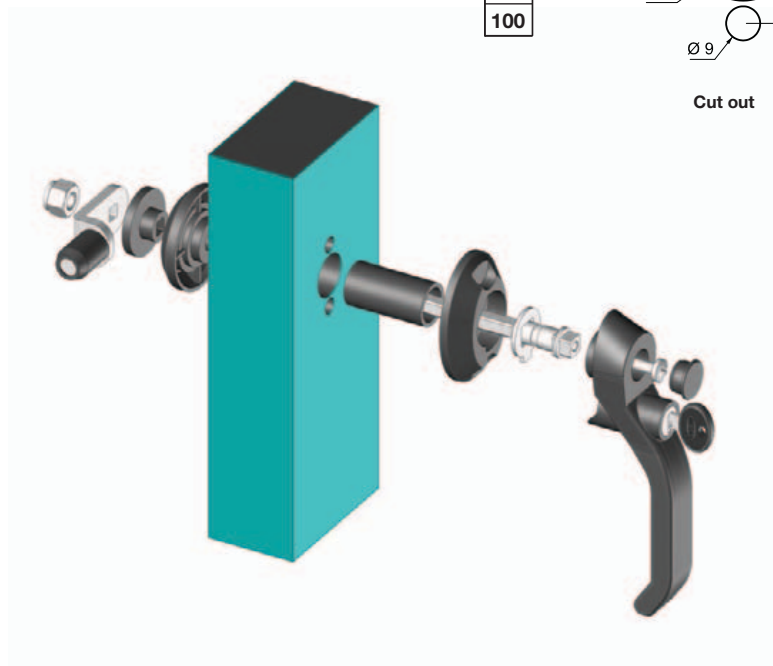
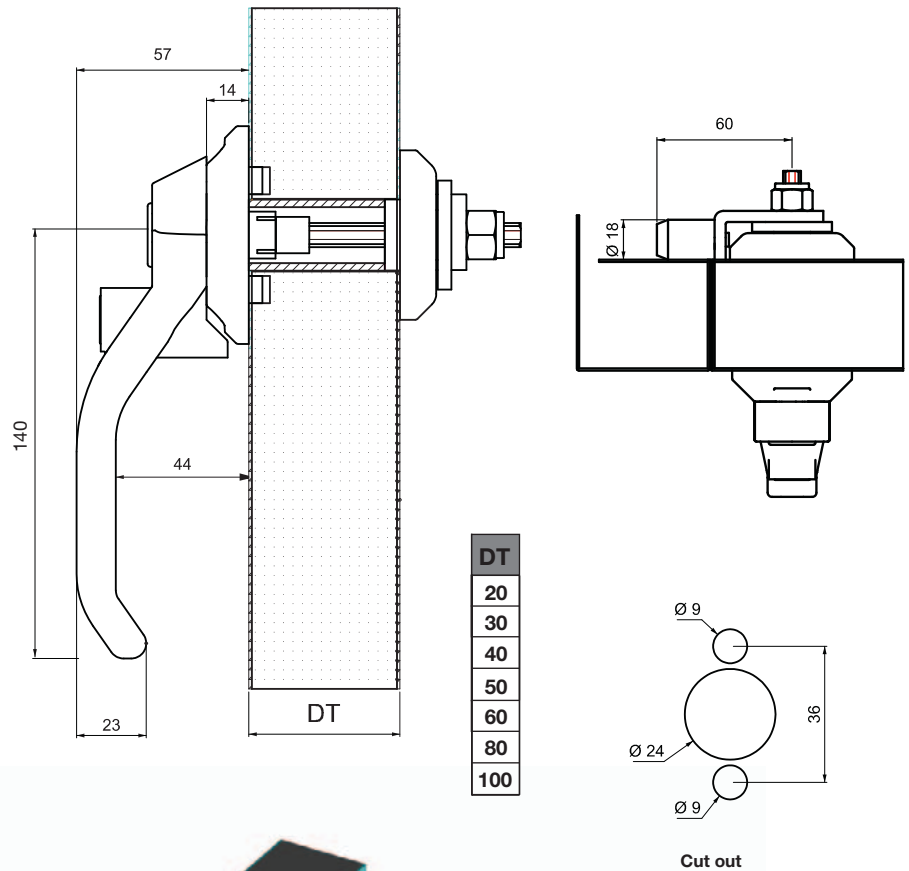

No Cylinder "00"

PRODUCT CODE

012 - 1 - DT - DD - 01

GROUP CODE VERSION DOOR THICKNESS CYLINDER CAM

Cylinder	SPECIFICATIONS	DD
	No Cylinder	00
	Keyed alike	01
	Keyed differ	02
	Euro key (5333)	05

012 A1

INTERNAL SAFETY HANDLE

New

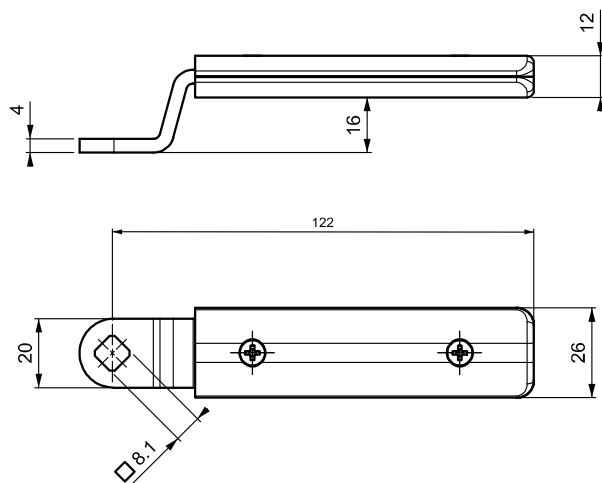

- Internal safety handle can only be used when the external handle is at unlocking position.
- Internal safety handle is optional accessory

MATERIAL

Polyamide DIN-EN ISO 1043-1 PA6 GFR 30 and steel

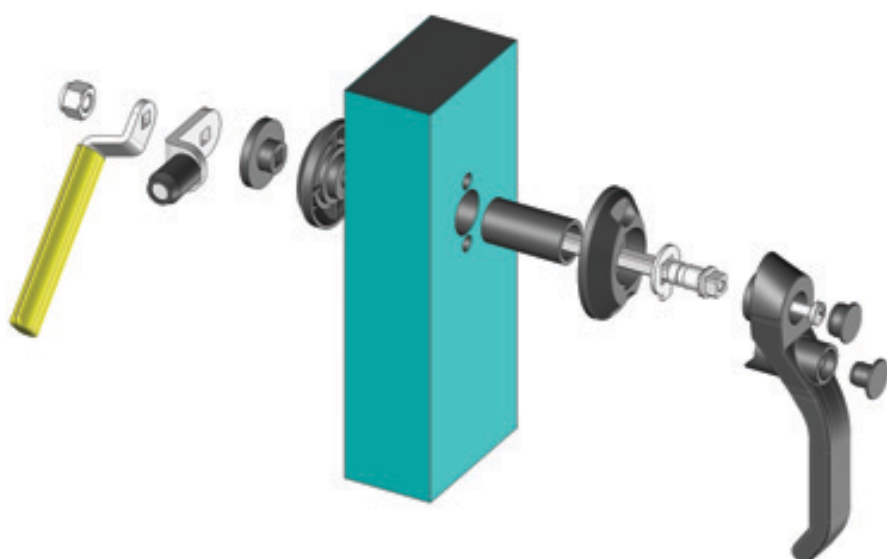

COMPRESSION LOCK

077

New



LH/RH

RoHS



- With cylinder or without cylinder versions.
- 24-46 mm grip adjustment is possible
- Suitable for max 2 mm door thickness
- Assembly of the lock can be made with one fixing bracket

APPLICATIONS

Generators, compressor electric panels, machinery covers

MATERIAL

BODY : Zamak DIN-EN 1774-ZnAl4Cu1

HANDLE : Zamak DIN-EN 1774-ZnAl4Cu1

V : 1

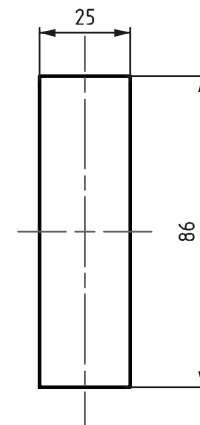
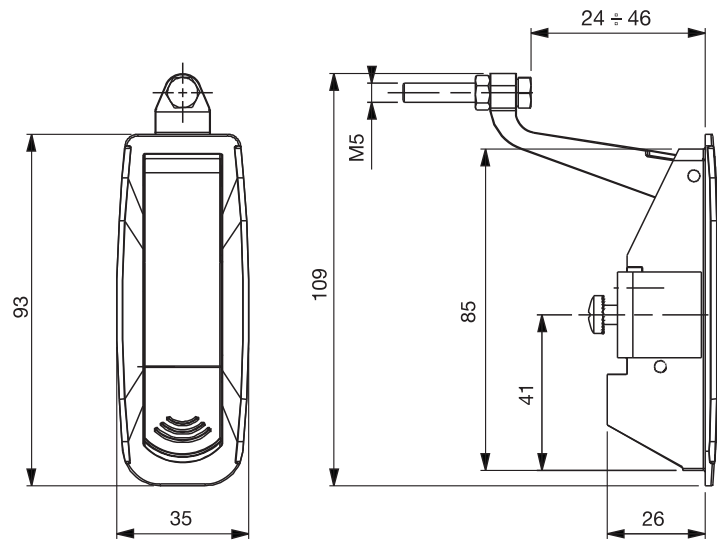

Cut out

PRODUCT CODE

077 - 1 - F - DD

GROUP CODE VERSION FINISH CYLINDER

FINISH	F
Chrome	1
Black Coated	2

SPECIFICATIONS	DD
No Cylinder	00
Keyed alike	01
Keyed differ	02

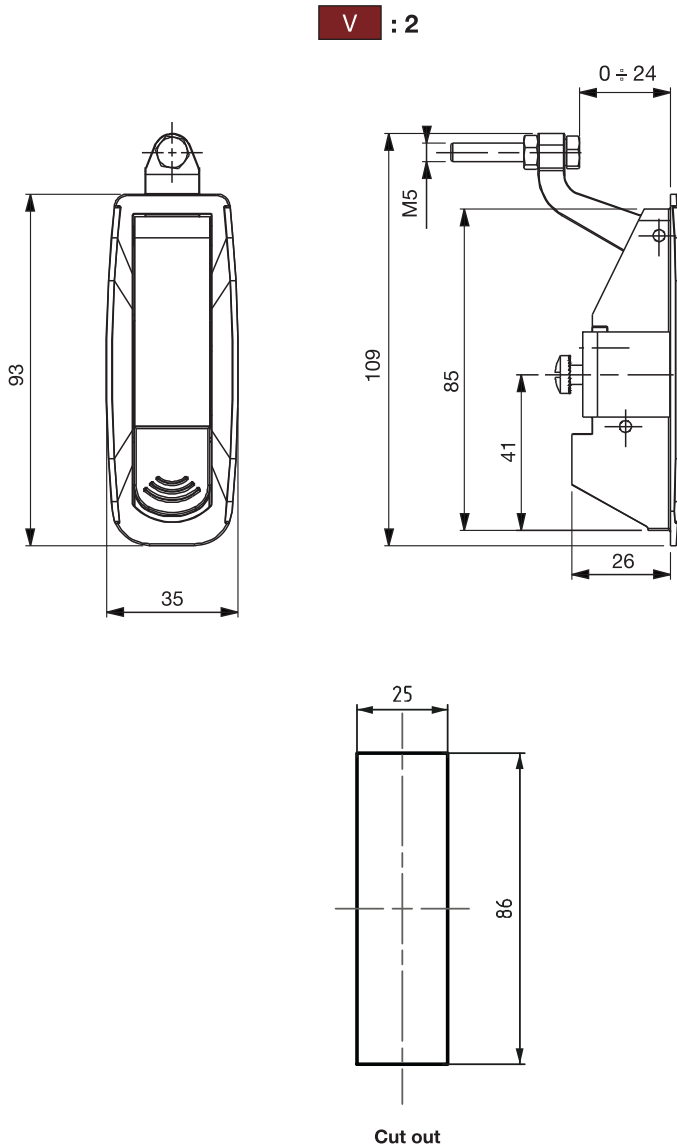

077

COMPRESSION LOCK

New



LH/RH

RoHS



- With cylinder or without cylinder versions.
- 0-24 mm grip adjustment is possible
- Suitable for max 2 mm door thickness
- Assembly of the lock can be made with one fixing bracket

PRODUCT CODE

077 - **2** - **F** - **DD**

GROUP CODE VERSION FINISH CYLINDER

FINISH	F
Chrome	1
Black Coated	2

SPECIFICATIONS	DD
No Cylinder	00
Keyed alike	01
Keyed differ	02

APPLICATIONS

Generators, compressor electric panels, machinery covers

MATERIAL

BODY : Zamak DIN-EN 1774-ZnAl4Cu1
HANDLE : Zamak DIN-EN 1774-ZnAl4Cu1